

The RF Line

CATV Amplifier Module

Features

- Specified for 77-, 110- and 128-Channel Loading
- Excellent Distortion Performance
- Silicon Bipolar Transistor Technology
- Unconditionally Stable Under All Load Conditions

Applications

- CATV Systems Operating in the 40 to 870 MHz Frequency Range
- Input Stage Amplifier in Optical Nodes, Line Extenders and Trunk Distribution Amplifiers for CATV Systems
- Driver Amplifier in Linear General Purpose Applications
- Output Stage Amplifier on Applications Requiring Low Power Dissipation

Description

- 24 Vdc Supply, 40 to 870 MHz, CATV Forward Amplifier

MHW8202B

870 MHz
20.9 dB GAIN
128-CHANNEL
CATV AMPLIFIER

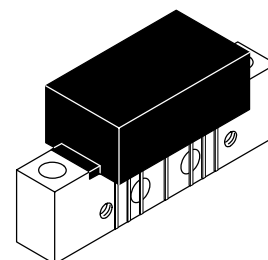

CASE 1302-01, STYLE 1

ARCHIVE INFORMATION

ARCHIVE INFORMATION

MAXIMUM RATINGS

Rating	Symbol	Value	Unit
DC Supply Voltage	V_{CC}	+28	Vdc
RF Input Voltage (Single Tone)	V_{in}	+70	dBmV
Operating Case Temperature Range	T_C	-20 to +100	°C
Storage Temperature Range	T_{stg}	-40 to +100	°C

ELECTRICAL CHARACTERISTICS ($V_{CC} = 24$ Vdc, $T_C = +30^\circ\text{C}$, 75 Ω system unless otherwise noted)

Characteristic	Symbol	Min	Typ	Max	Unit
Frequency Range	BW	40	—	870	MHz
Power Gain f = 50 MHz f = 870 MHz	G_p	19.8 20.3	20.4 20.9	20.8 21.8	dB
Slope (f = 40 - 870 MHz)	S	—	0.5	1.2	dB
Gain Flatness (Peak To Valley) (f = 40 - 870 MHz)	G_F	—	0.4	0.6	dB
Input/Output Return Loss @ f = 40 MHz	IRL/ORL	20	21	—	dB
Derate Return Loss @ f > 40 MHz	RLD	—	—	0.005	dB/MHz
Composite Second Order ($V_{out} = +38$ dBmV/ch; 128-Channels, Worst Case) ($V_{out} = +40$ dBmV/ch; 110-Channels, Worst Case) ($V_{out} = +44$ dBmV/ch; 77-Channels, Worst Case)	CSO_{128} CSO_{110} CSO_{77}	— — —	-71 -70 -75	-66 -65 -70	dBc

ELECTRICAL CHARACTERISTICS — continued ($V_{CC} = 24$ Vdc, $T_C = +30^\circ\text{C}$, 75 Ω system unless otherwise noted)

Characteristic	Symbol	Min	Typ	Max	Unit
Cross Modulation Distortion ($V_{out} = +38$ dBmV/ch, 128-Channels, Worst Case) ($V_{out} = +40$ dBmV/ch, 110-Channels, Worst Case) ($V_{out} = +44$ dBmV/ch, 77-Channels, Worst Case)	XMD ₁₂₈ XMD ₁₁₀ XMD ₇₇	— — —	- 67 - 65 - 58	- 62 - 61 - 57	dBc
Composite Triple Beat ($V_{out} = +38$ dBmV/ch, 128-Channels, Worst Case) ($V_{out} = +40$ dBmV/ch, 110-Channels, Worst Case) ($V_{out} = +44$ dBmV/ch, 77-Channels, Worst Case)	CTB ₁₂₈ CTB ₁₁₀ CTB ₇₇	— — —	- 67 - 66 - 65	- 63 - 63 - 63	dBc
Noise Figure $f = 50$ MHz $f = 750$ MHz $f = 870$ MHz	NF	— — —	3.8 5.0 5.6	5.0 6.5 7.0	dB
DC Current	I_{DC}	180	220	240	mA

ARCHIVE INFORMATION

ARCHIVE INFORMATION



NOTES

ARCHIVE INFORMATION

ARCHIVE INFORMATION

PACKAGE DIMENSIONS

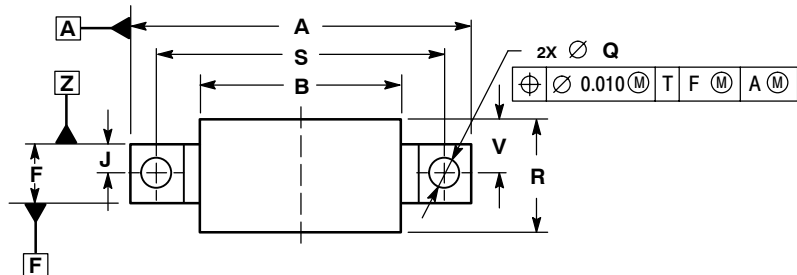

NOTES:
 1. DIMENSIONS ARE IN INCHES.
 2. INTERPRET DIMENSIONS AND TOLERANCES PER ASME Y14.5M, 1994.

DIM	INCHES		MILLIMETERS	
	MIN	MAX	MIN	MAX
A	---	1.775	---	45.085
B	---	1.085	---	27.559
C	---	0.840	---	21.336
D	0.015	0.021	0.381	0.533
E	0.465	0.510	11.811	12.954
F	0.300	0.325	7.62	8.255
G	0.100 BSC		2.540 BSC	
J	0.156 BSC		3.962 BSC	
K	0.315	0.355	8.001	9.017
L	1.000 BSC		25.400 BSC	
N	0.165 BSC		4.191 BSC	
P	0.100 BSC		2.540 BSC	
Q	0.148	0.168	3.759	4.267
R	---	0.600	---	15.24
S	1.500 BSC		38.100 BSC	
U	0.200 BSC		5.080 BSC	
V	---	0.250	---	6.350
W	0.435	---	11.049	---
X	0.400 BSC		10.160 BSC	
Y	0.152	0.163	3.861	4.140
Z	0.009	0.011	0.229	0.279

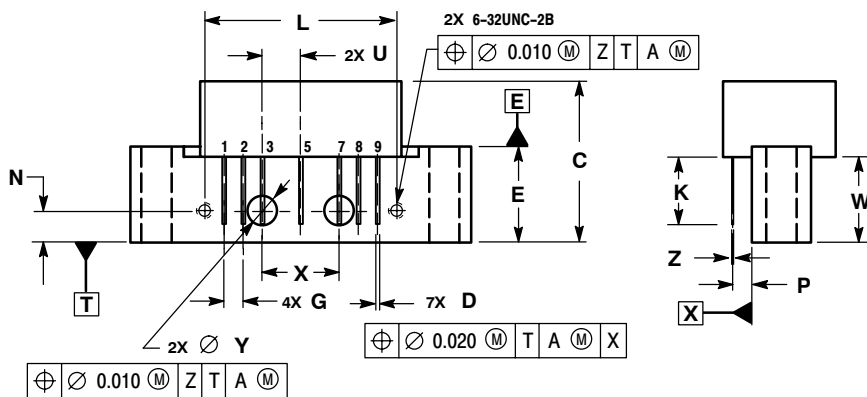

STYLE 1:
 PIN 1. RF INPUT
 2. GROUND
 3. GROUND
 4. DELETED
 5. VDC
 6. DELETED
 7. GROUND
 8. GROUND
 9. RF OUTPUT

CASE 1302-01
 ISSUE B

ARCHIVE INFORMATION

ARCHIVE INFORMATION

Motorola reserves the right to make changes without further notice to any products herein. Motorola makes no warranty, representation, or guarantee regarding the suitability of its products for any particular purpose, nor does Motorola assume any liability arising out of the application or use of any product or circuit, and specifically disclaims any and all liability, including without limitation consequential or incidental damages. "Typical" parameters can and do vary in different applications and actual performance may vary over time. All operating parameters, including "Typicals", must be validated for each customer application by customer's technical experts. Motorola does not convey any license under its patent rights nor the rights of others. Motorola products are not designed, intended, or authorized for use as components in systems intended for surgical implant into the body, or other applications intended to support or sustain life, or for any other application in which the failure of the Motorola product could create a situation where personal injury or death may occur. Should Buyer purchase or use Motorola products for any such unintended or unauthorized application, Buyer shall indemnify and hold Motorola and its officers, employees, subsidiaries, affiliates, and distributors harmless against all claims, costs, damages, and expenses, and reasonable attorney fees arising out of, directly or indirectly, any claim of personal injury or death associated with such unintended or unauthorized use, even if such claim alleges that Motorola was negligent regarding the design or manufacture of the part. Motorola and the Stylized M Logo are registered in the US Patent & Trademark Office. All other product or service names are the property of their respective owners. Motorola, Inc. is an Equal Opportunity/Affirmative Action Employer.

© Motorola, Inc. 2002.

How to reach us:

USA/EUROPE/Locations Not Listed: Motorola Literature Distribution; P.O. Box 5405, Denver, Colorado 80217. 1-303-675-2140 or 1-800-441-2447

JAPAN: Motorola Japan Ltd.; SPS, Technical Information Center, 3-20-1, Minami-Azabu. Minato-ku, Tokyo 106-8573 Japan. 81-3-3440-3569

ASIA/PACIFIC: Motorola Semiconductors H.K. Ltd.; Silicon Harbour Centre, 2 Dai King Street, Tai Po Industrial Estate, Tai Po, N.T. Hong Kong. 852-26668334

Technical Information Center: 1-800-521-6274

HOME PAGE: <http://www.motorola.com/semiconductors/>